

# Aircell®

Panel | Intermediate layer | Individual

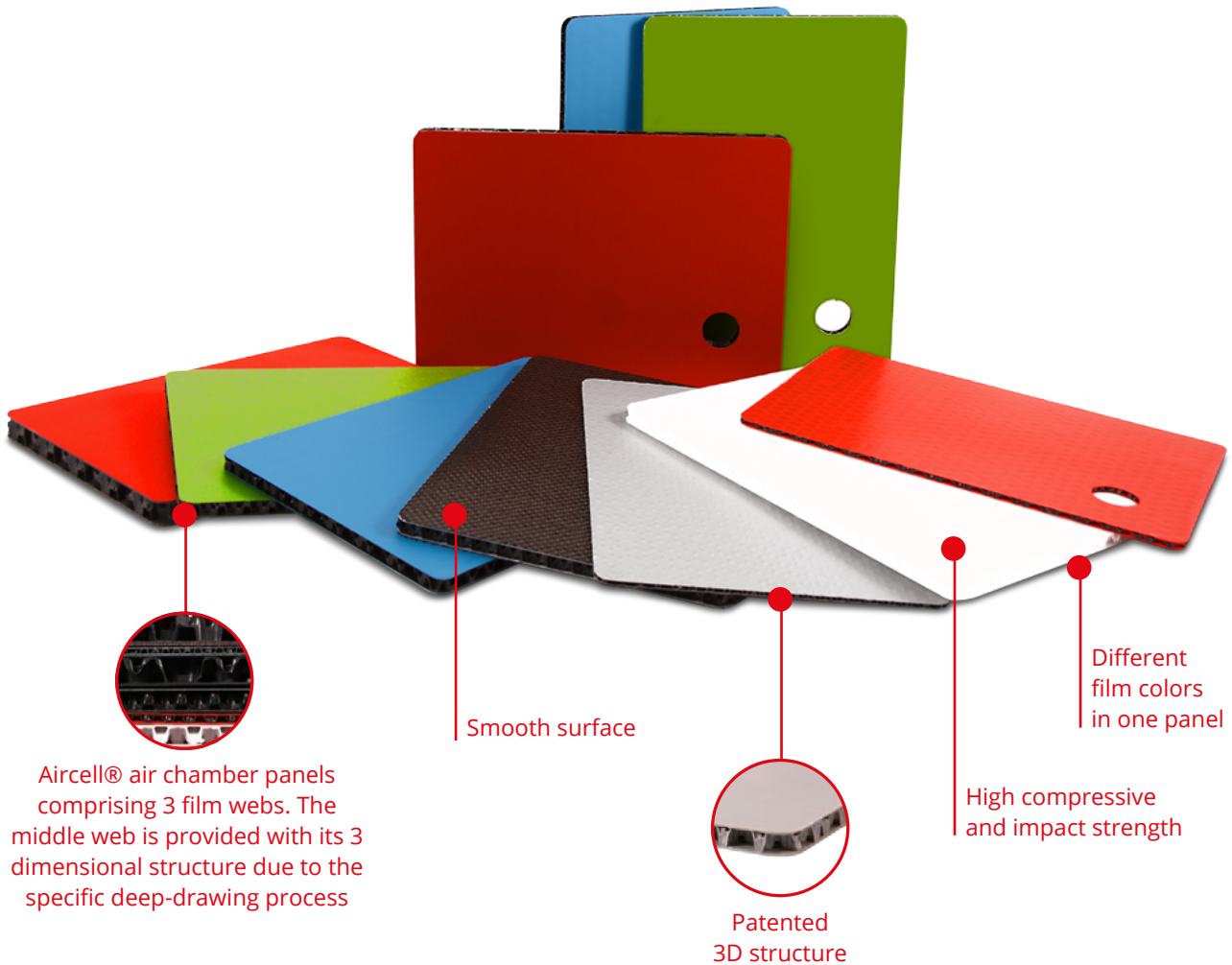

## Aircell® features

- ✓ Food-safe
- ✓ Individual **color design**
- ✓ Surface coating with **textile, foam, fleece**
- ✓ Surface coating with anti-slip (**TPE**)
- ✓ Edges open or closed
- ✓ Deep drawn air chamber panels made of **PP, PS, ABS, HDPE**
- ✓ **Ultra-light** with extreme **stability**
- ✓ Material thicknesses **3 to 30 mm**
- ✓ **Thermal** and acoustic insulating
- ✓ Optional: execution in **ESD**



**100 %  
Recyclable**



**Weather and  
moisture resistant**



**Corrosion and  
rot-proof**



## Weights and volumes

Type	3/1000	5/1500	5/2000	9/2300	10/2500	10/3000	10/4000	15/5000	16/5000
Total thickness (mm)	3 ± 0,4	5 ± 0,4	5 ± 0,4	9 ± 0,4	10 ± 0,4	10 ± 0,4	10 ± 0,4	15 ± 0,5	16 ± 0,5
Surface weight (g/m <sup>2</sup> )	1000 ± 50	1500 ± 60	2000 ± 100	2300 ± 100	2500 ± 100	3000 ± 100	4000 ± 150	5000 ± 200	5000 ± 200



## Physical properties

Type	3/1000	5/1500	5/2000	9/2300	10/2500	10/3000	10/4000	15/5000	16/5000
Bending force max. (F max. in N)	≥ 45	≥ 100	≥ 150	≥ 250	≥ 400	≥ 450	≥ 650	≤ 900	≤ 800
Deflection at F max. (mm)	≥ 4,5	≥ 4,5	≥ 5,5	≥ 4,5	≥ 5	≥ 5	≥ 6	≤ 8	≥ 6,5
Elasticity module (MPa)	≥ 0,15	≥ 0,5	0,5	≥ 1,5	≥ 2,5	≥ 3,0	≥ 3	6	≥ 4
Cold resistance (-20°C) (mm)	≤ 100	≥ 150	≥ 150	200	200	230	300	500	450

## Aircell® Luftkammerplatten

The patented air chamber panels made of plastic from wi-sales, one of the most innovative plastic experts in Germany, are stable, simple, cost-effective and in-particular, lighter! The super stable ultra lightweight only weighs one third of a comparable solid plate but is just as stable and on top, is much more cost effective.



You determine the version. By colored surfaces or an individual print, by additional properties such as an anti-slip coating and / or a textile / fleece finishing.

Our lightweight for tough tasks – the Aircell® air chamber panels 15/5000 and 16/6000 – unique in manufacturing and use. The multi talent for your very special challenges.

## Application range

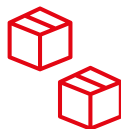

### Packaging area:

- Foldable reusable load carrier
- Container rings for pallet and cover systems
- Intermediate inserts and inserts
- Stacking container and special packaging

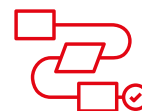

### Pallet processing:

- Load floors and side walls
- Covers (spare wheel, luggage compartment)
- Display and partition walls
- Suitcase inserts
- Advertising boards